

IKO Linear Way H : Flange type

Flange type mounted from top
LWHT ...B
LWHTG
LWHT ...SL (Stainless steel made)
LWHT ...M (Ultra sealed type)

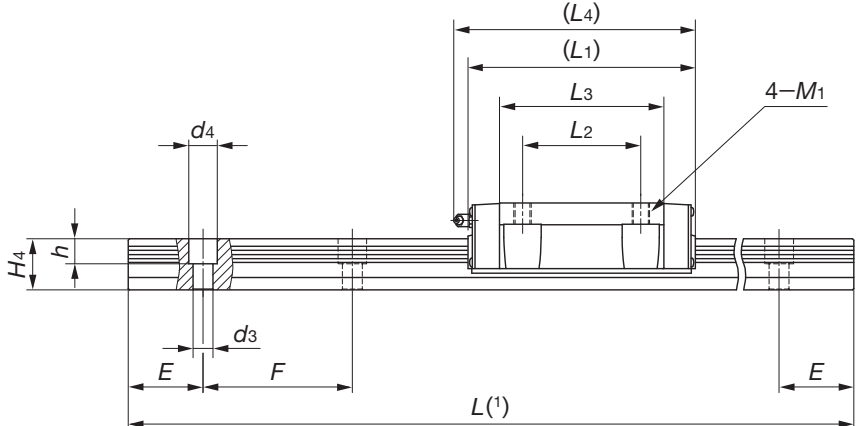
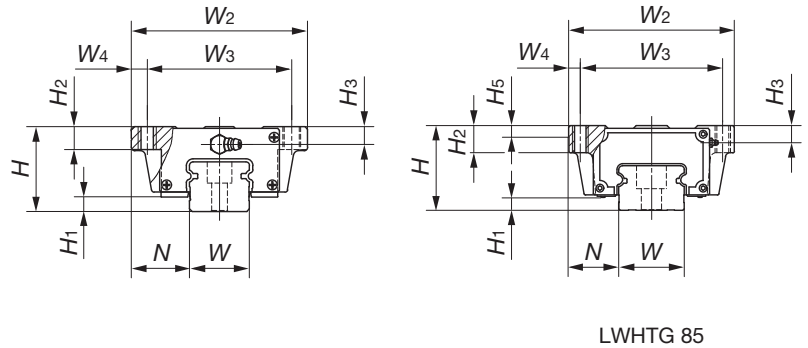

Model number	Interchangeable	Mass (Ref.)		Dimensions of assembly mm			Dimensions of slide unit mm																				
		Slide unit kg	Track rail kg/m	H	H ₁	N	W ₂	W ₃	W ₄	L ₁	L ₂	L ₃	L ₄	M ₁													
LWHT 30...B	☆	1.28	4.82	42	7	31	90	72	9	113	52	80.6	124	M 10													
LWHT 30...SL	☆																										
LWHT 30...M																											
LWHTG 30	☆	1.69								139		106.6	150														
LWHT 35...B	☆	1.79	6.85	48	8	33	100	82	9	123	62	86.2	135	M 10													
LWHT 35...M																											
LWHTG 35	☆														2.35								151		114	163	
LWHT 45...B	☆	3.17	10.7	60	10	37.5	120	100	10	147	80	103.4	158	M 12													
LWHT 45...M																											
LWHTG 45	☆														4.34								190		146.6	201	
LWHT 55...B	☆	5.30	15.5	70	13	43.5	140	116	12	183	95	132	194	M 14													
LWHTG 55	☆														7.40								235		183.6	246	
LWHT 65...B	☆														12.3	22.2	90	14	53.5	170	142	14	229	110	164	239	M 16
LWHTG 65	☆	17.6								303		238.8	313														
LWHTG 85		25.9	34.6	110	16	65	215	185	15	318	140	240	—	M 20													

Note⁽¹⁾ : Track rail lengths are shown in Table 11.1 on page B-90, Table 11.2 on page B-91 and Table 11.3 on page B-92.
⁽²⁾ : The directions of basic dynamic load rating (C), basic static load rating (C₀) and static moment rating (T₀, T_x, T_y) are shown in the sketches below. The upper values in the T_x and T_y columns apply to one slide unit, and the lower values apply to two slide units in close contact.
 Remark 1 : The mark ☆ indicates that interchangeable specification products are available.
 2 : The appended track rail mounting bolts are hexagon socket head bolts of JIS B 1176 or equivalent.
 For stainless steel type Linear Way H, stainless steel bolts are appended.
 3 : For grease nipple specifications, see page 99.

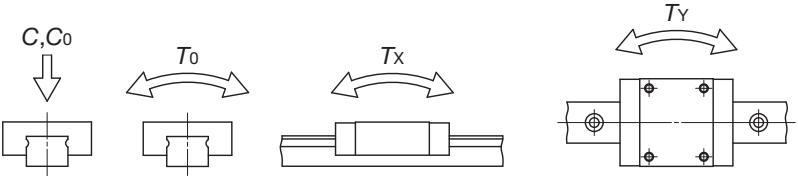

			Dimensions of track rail mm							Mounting bolt for track rail mm	Basic dynamic load rating ⁽²⁾	Basic static load rating ⁽²⁾	Static moment rating ⁽²⁾			
H ₂	H ₃	H ₅	W	H ₄	d ₃	d ₄	h	E	F	Bolt size × length	C	C ₀	T ₀	T _x	T _y	
												N	N	N·m	N·m	N·m
10	8	—	28	25	9	14	12	40	80	M 8×28	35 400	40 700	623	536 2 820	536 2 820	
											42 700	53 200	814	894 4 460	894 4 460	
13	10	—	34	28	9	14	12	40	80	M 8×28	48 700	53 700	823	631 3 480	579 3 190	
											59 500	71 600	1 100	1 090 5 570	1 000 5 110	
15	13	—	45	34	14	20	17	52.5	105	M12×35	74 600	80 200	1 610	1 150 6 190	1 060 5 690	
											95 200	114 000	2 280	2 240 11 100	2 050 10 200	
17	14	—	53	41	16	23	20	60	120	M14×45	113 000	121 000	2 870	2 210 11 600	2 030 10 600	
											142 000	168 000	3 970	4 120 20 200	3 780 18 500	
23	20	—	63	48	18	26	22	75	150	M16×50	176 000	184 000	5 180	4 130 22 000	3 790 20 200	
											229 000	269 000	7 560	8 530 41 500	7 810 38 100	
35	22	15	85	58	26	39	30	90	180	M24×60	374 000	384 000	11 900	11 100 55 100	11 100 55 300	

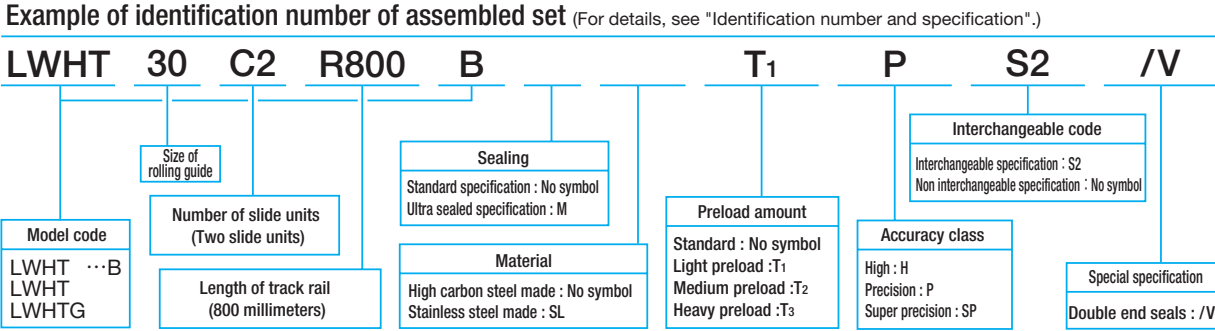

B
 LWHT, LWHTG, LWHTD, LWHS, LWHY